

# PRODUCT SPECIFICATION

CONNECT

IT

## EUROLAN DIN rail adapter keystone



### Ordering information

Part number	E-number	Description
16B-00-42WT	5140117	Eurolan DIN rail adapter for keystone white

### Technical information

Surface mounting	Yes
Flush-mounted installation/built-in installation	No
Duct installation	No
Floor box/subfloor mounted	No
Type of fastening	DIN rail (top hat rail)
Type of connector	Suitable for Eurolan keystone
Color	White RAL 9010
Material connector housing	Plastic
With buses/couplings	No
Suitable for number of connectors	1
Shielded housing	No
Separate earthing connection	No
With label space	Yes
Outlet direction	Inclined
With dust cover	Yes
Degree of protection (IP)	IP20
Covered by the RoHS Directive Y/N if Yes name the version	Yes EU RoHS Directive 2011/65/EU and Directive (EU) 2015/863
Includes hazardous minerals Y/N	No
PoE level	Not applicable



- For external mounting on DIN rail. 1xEurolan keystone, unshielded and shielded
- Cable entry at the back
- RAL 9010 and halogen free (LSZH)
- Size (WxLxH) 21x67x70mm
- The body of the panel is made of galvanized steel.
- Follows the RoHS directives

# PRODUCT SPECIFICATION

CONNECT

IT

EUROLAN

## DIN rail adapter keystone

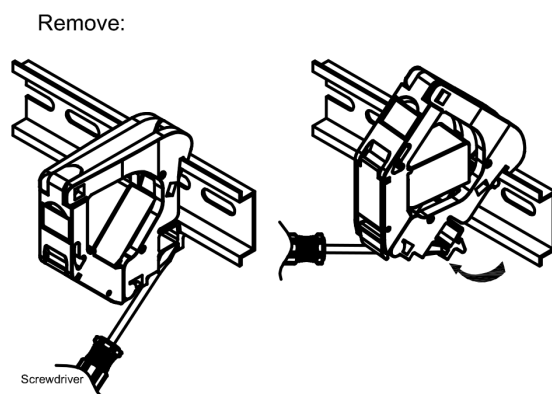
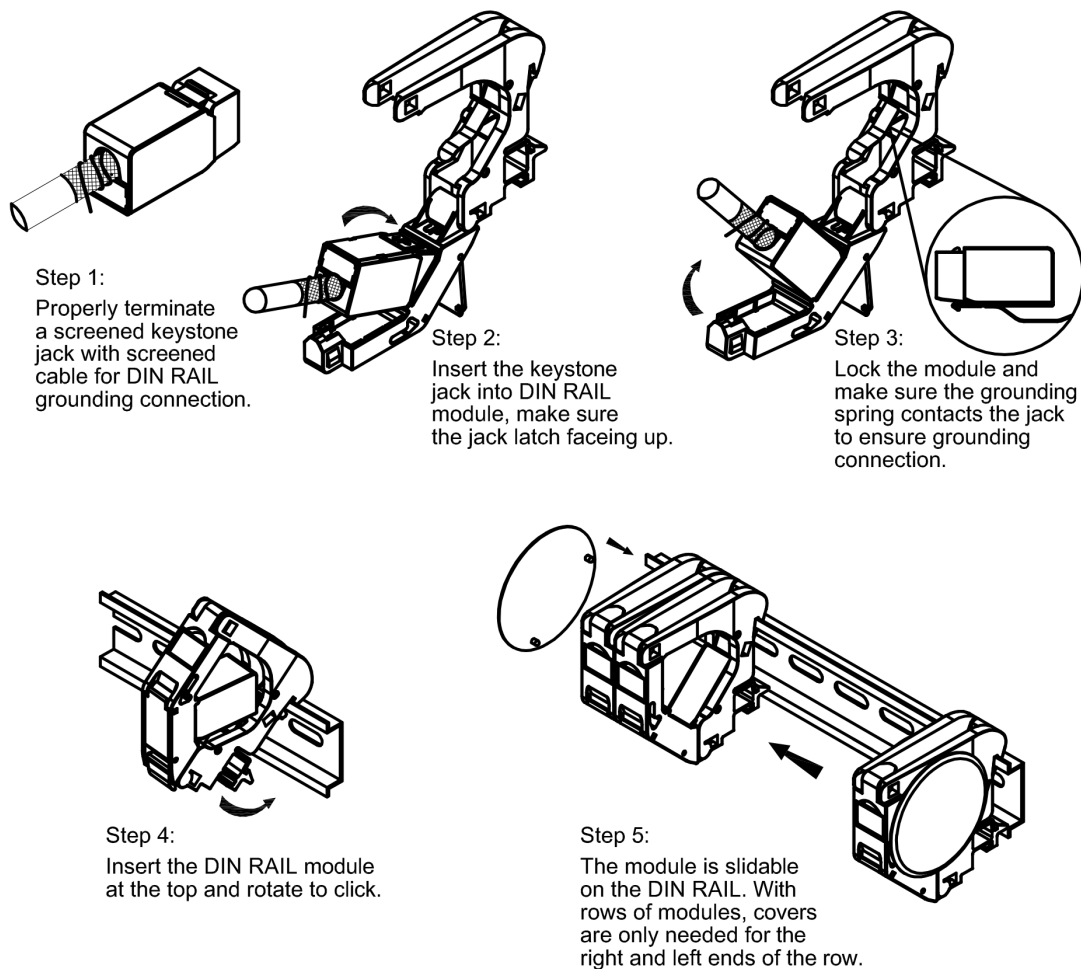

Insert a screwdriver into the opening at the bottom of the module and use it as a lever to pull out the module.

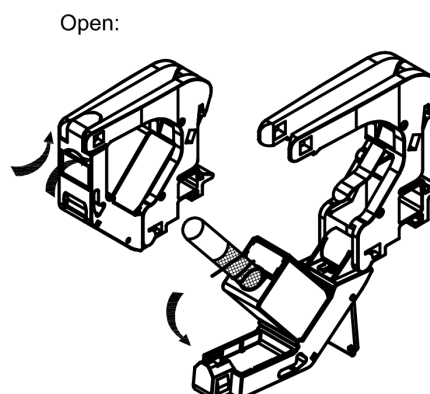

Use screwdrivers or fingers to open the poles at the top of the module.